

# Johnstone's StainAway. Stronger than stains.

Johnstone's StainAway wall and ceiling paint contains Stain Blocking Technology to permanently isolate stains and leave a durable flat matt finish.

The innovative Stain Blocking Technology permanently isolates even the most persistent stains, including smoke, nicotine and water. StainAway also has high opacity, class 1 scrub resistance and leaves a smooth flat matt finish.

When working with stained walls and ceilings, there is no need to use a separate primer and finish. Johnstone's StainAway will do both jobs in one, saving you time on the job.

## PRODUCT INFORMATION

- STAIN BLOCKING TECHNOLOGY
- PRIMER AND FINISH IN ONE
- SMOOTH FLAT MATT FINISH
- CLASS 1 SCRUB RATING ISO 11998



## Stain Blocking Technology

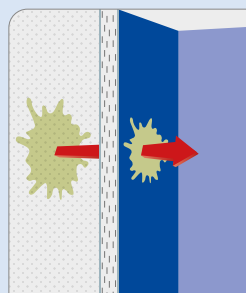

Without Stain blocking technology

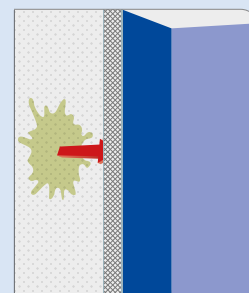

With Stain blocking technology

Johnstone's StainAway has stain blocking technology containing cross linking polymer compounds in the paint layer ensuring stains are covered permanently.

Use on



Interior

Substrate

Walls, Ceilings,  
Concrete,  
Plaster and  
Plasterboard.

Application



Brush, roller & spray

Finish

**FLAT  
MATT**

Recoat



4hrs

Pack Size



2.5L, 5L & 10L

Type

**WATER  
BASED**

Coverage

**Up to 9  
M<sup>2</sup>/LTR**

Colours



Brilliant White  
and L Base

Available in the the Johnstone's Trade Voice of Colour palette.